

SF 2500 with BLACK CASE

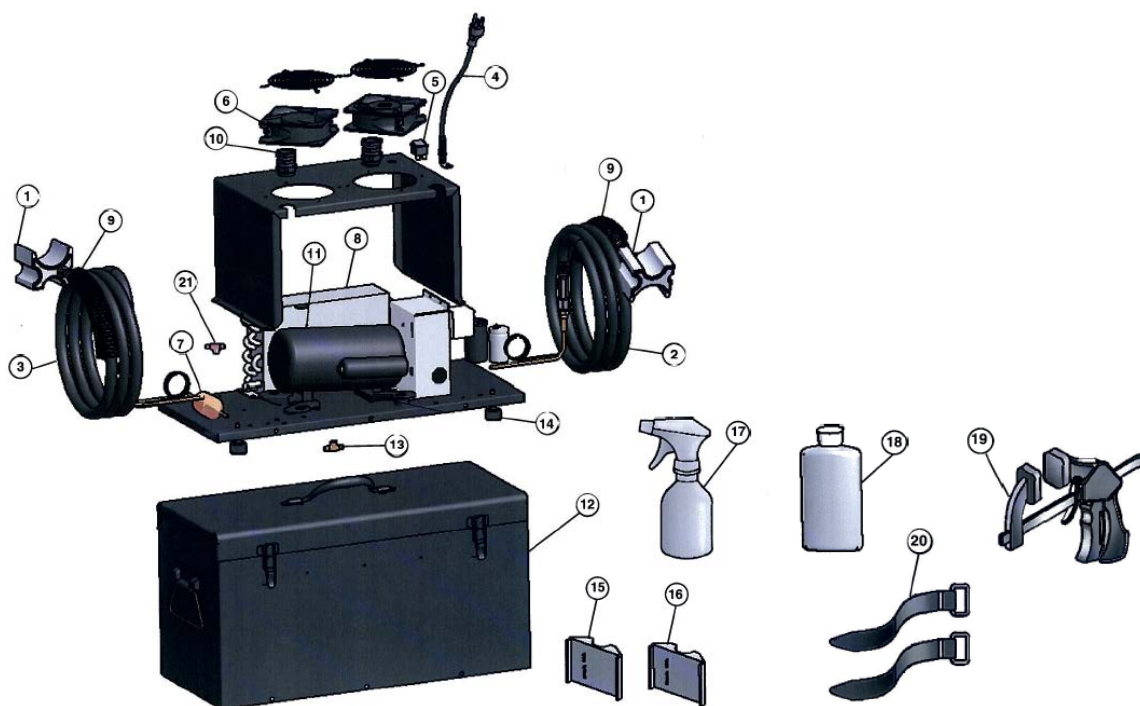

| ITEM | CATNO | DESCRIPTION |
|------|-------|--|
| 1 | 70356 | EVAPORATOR, FOR 2" BP, PKGD |
| 2 | 32878 | HOSE,ASSY,O-RING,ACS VAL, PKGD |
| 3 | 32883 | HOSE,ASSY,O-RING, PKGD |
| 4 | 65922 | CORDSET, 230\1, PKGD |
| 5 | 65932 | SWITCH, ROCKER, W/PROT COVER, PKG |
| 6 | 66457 | FAN, 230\1, PKGD |
| 7 | 70386 | DRYER, FILTER, 1-5/8"D, PKGD |
| 8 | 32863 | CONDENSING, NEW, PKGD |
| 9 | 68756 | SPRING, PROTECTIVE, SET OF 2, PKGD |
| 10 | 65927 | FITTING, STRAIN RELIEF, SET OF 2, PKGD |
| 11 | - | COMPRESSOR, PKGD |
| 12 | 32893 | KIT, CASE & BASE, BLACK |
| 13 | 68676 | FITTING, TEE, 114 X 3/8, PKGD |
| 14 | 68746 | FEET, RUBBER, SET OF 4, PKGD |
| 15 | 68862 | END ADPATER, 22MM, SET OF 2 |
| 16 | 72422 | END ADPATER, 28MM, SET OF 2 |
| 17 | 60775 | SPRAY BOTTLE AND TRIGGER |
| 18 | 74946 | GEL, COOL ,80Z |
| 19 | 65942 | CLAMP, PKGD |
| 20 | 69707 | VELCRO STRAPS, 1'X16", SETOF 2, PKGD |
| 21 | 71337 | FITTING, TEE, COPPER, 5/16, PKGD |